

## RLC2IC

# Miniature Incremental Magnetic Encoder Module

RLC2IC is a PCB-level incremental encoder system consisting of a PCB sensor and a magnetic scale or ring. It is designed for embedded motion control applications as a position control loop element in applications with limited space.

The state-of-the-art position detection guarantees a highly repeatable position measurement under wide mounting tolerances and temperature ranges. Position information is output in incremental quadrature format with the option of a unique or periodic reference mark (each pole).

SMALL SIZE  
& SIMPLE  
INTEGRATION

UNIQUE  
REFERENCE  
MARK

HIGH  
OPERATING  
TEMPERATURE



## Features and benefits

- ▶ Miniature design
- ▶ Four different termination options
- ▶ Unique or periodic bidirectional reference mark
- ▶ Incremental quadrature output RS422
- ▶ Suitable for use with linear scales, radial and axial rings
- ▶ High system accuracy up to  $\pm 10 \mu\text{m}$
- ▶ Non-contact and wear-free measuring principle



MEDICAL



PRINTING TECHNOLOGY



IN SMALL SIZE



ROBOTIC JOINTS



SMT PICK AND PLACE

## General information

The RLC2IC is a small PCB-level encoder with differential incremental signals and the possibility of a reference signal. The encoder can be ordered with different types of connectors or through-hole pads and is very suitable for applications with limited space.

### Choose your RLC2IC system

The robust RLC2IC readhead is compatible with the RLS incremental scale MS05 as well as the RLS axial and radial rings. You can select the length of the MS05 scale up to 50 m. There is also a wide range of axial and radial incremental rings available.

To ensure safety and reliability, the scale MS05 and the radial rings can be optionally covered with a protective stainless steel foil. Unique or distance-coded reference marks are also available to provide an even more reliable solution.

#### RLC2IC + magnetic scale

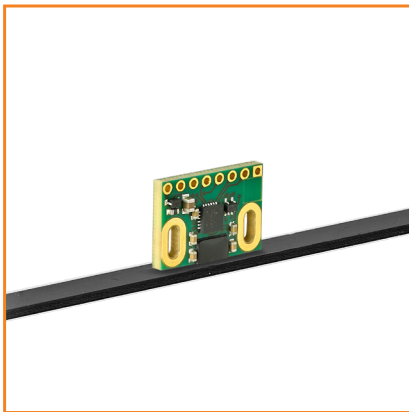

More about the MS magnetic scales can be found in the MSD01 at [RLS media center](#).

#### RLC2IC + radial magnetic ring



More about the radial rings can be found in the MR02D02 at [RLS media center](#).

#### RLC2IC + axial magnetic ring



More about the axial rings can be found in the MR01D01 at [RLS media center](#).

### Encoder variants

#### RLC2IC with Molex 5015681107

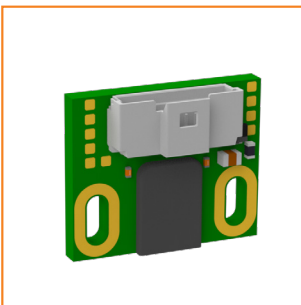

#### RLC2IC with AMPHENOL 10114828-11108LF

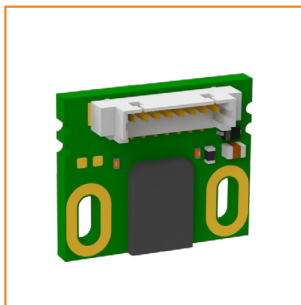

#### RLC2IC with Molex 527451197

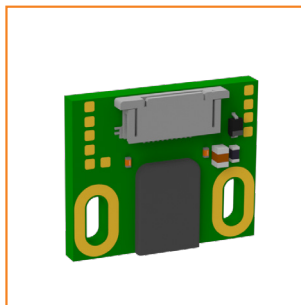

#### RLC2IC with through-hole pads

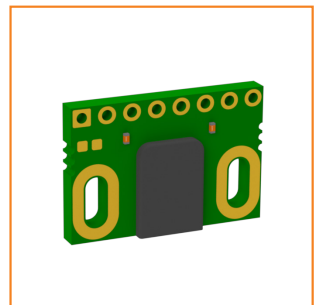

Images are for illustration purpose only.

## Storage and handling

All data given below refer to the readhead only. Complete systems with magnetic scale or ring may have other limitations. For more information, see the MSD01, MR02D02 or MR01D01 data sheets at [RLS Media center](#).

### Storage and operating temperature



Temperature	Product variant with
-40 °C to +85 °C	Molex 527451197
-40 °C to +105 °C	Molex 5015681107 AMPHENOL 10114828-11108LF
-40 °C to +125 °C	Through-hole

### Humidity



Up to 70 % non-condensing

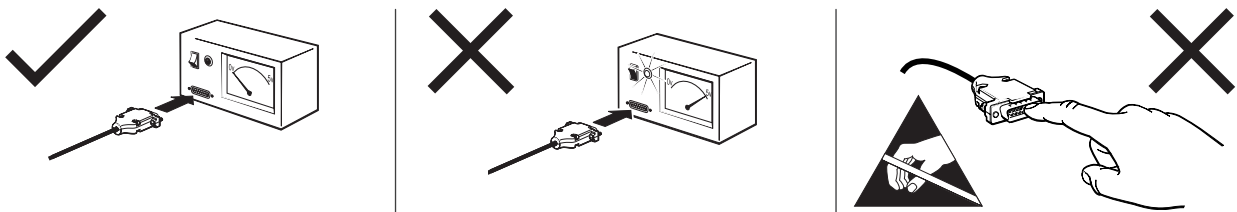

The encoder is a mechanically sensitive component. Handle it by its edges, touch it lightly, minimize pressure and eliminate bending while maintaining a secure grip to prevent falls. Maximize cleanliness. When it's not in use, place it in an ESD protective packaging (box or tray).

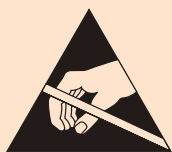

### Readhead is ESD sensitive - handle with care.

Do not touch electronic circuit, wires or sensor area without proper ESD protection or outside of ESD controlled environment.

## Packaging

Less than 20 units are individually packed in antistatic boxes. For quantities of 20 pieces or more, the readheads are packed in trays (see table below). The trays are packed together in a cardboard box (20 trays per box).

Product variant	Tray size	Box size
RLC2IC with through-hole pads	28 units per tray	20 trays per box
RLC2IC with connector	30 units per tray	

## Dimensions and installation drawings

Dimensions and tolerances are in mm. Dimensions without tolerance values are in accordance with ISO 2768-m.



### RLC2IC with Molex 527451197

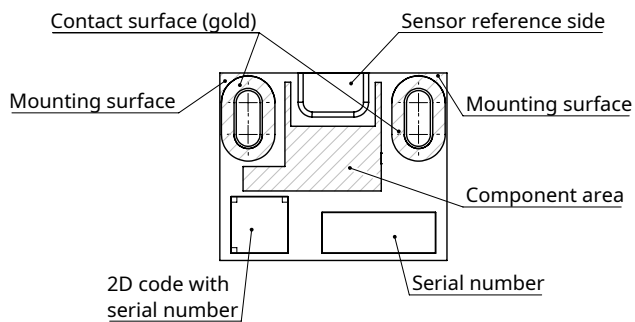
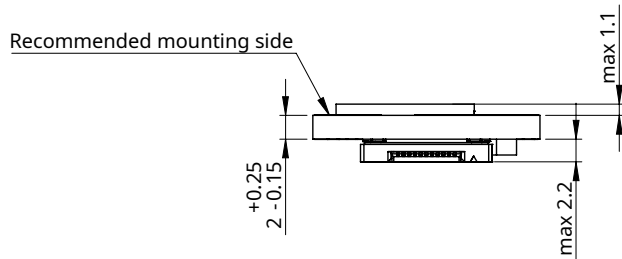
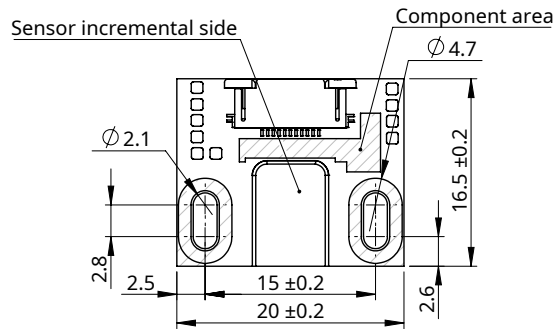

### RLC2IC with Molex 5015681107

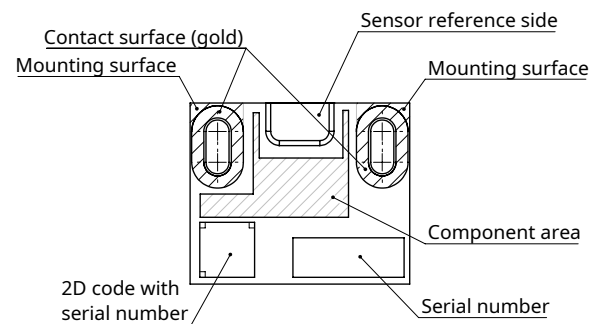
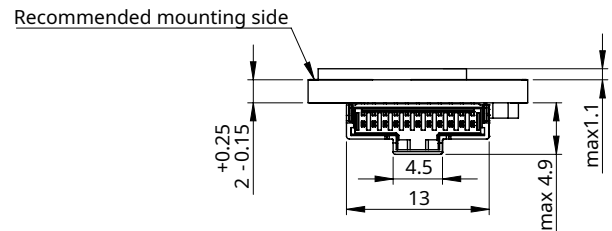
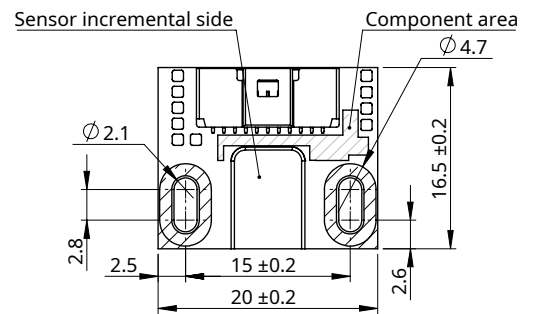

## RLC2IC with AMPHENOL 10114828-11108LF

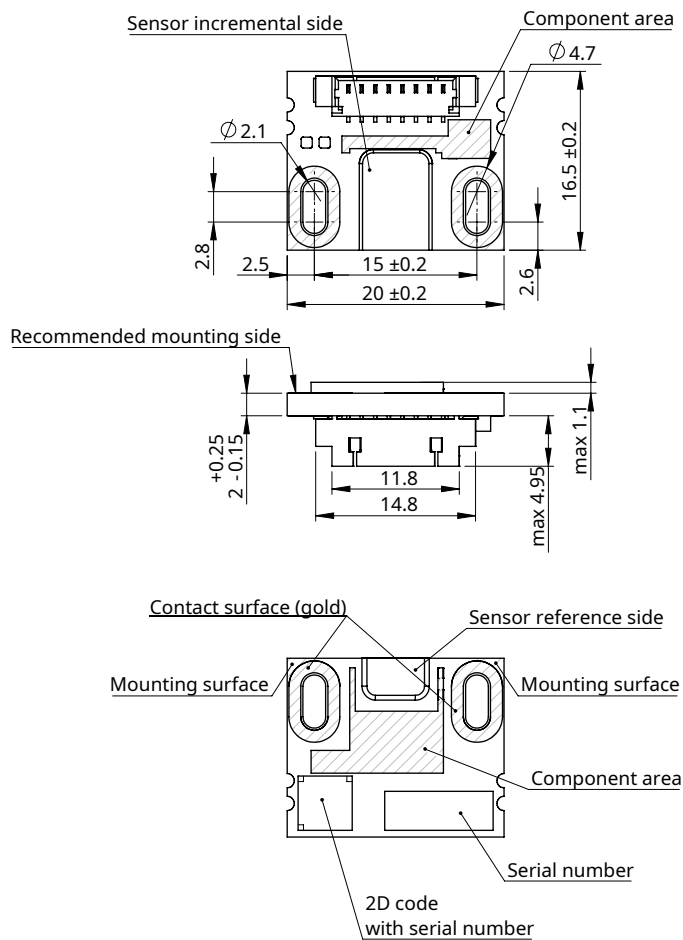

## RLC2IC through-hole pads

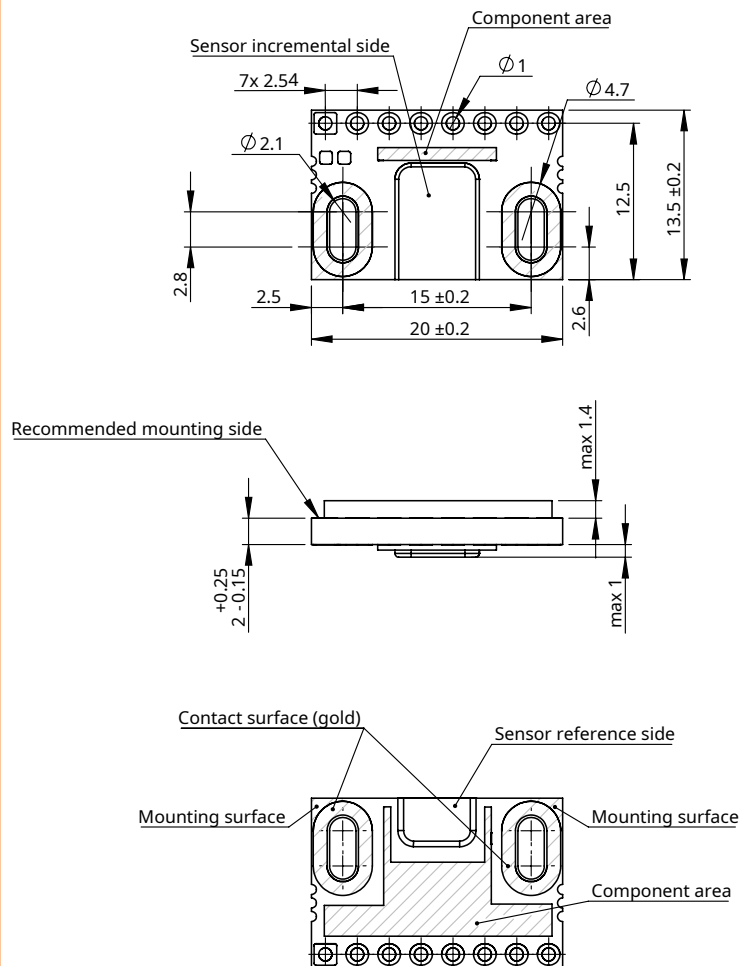

## Installation instructions

When mounting the RLC2IC, make sure that only the mounting surfaces of the PCB assembly are in contact with the mounting bracket. All other parts of the PCB assembly should maintain a minimum distance of 0.1 mm from other metal objects. All permissible distance and angle tolerances must be strictly complied according to the mounting instructions found at MSD01, MR01D01 or MR02D02 data sheets at [RLS Media center](#).

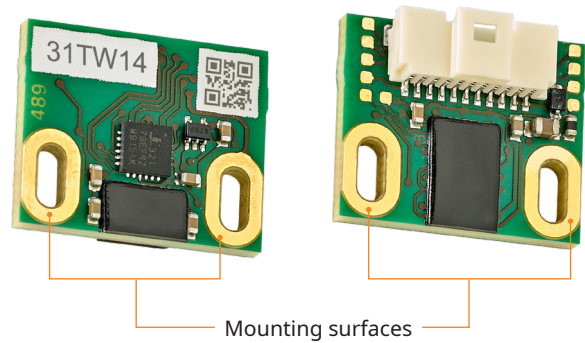
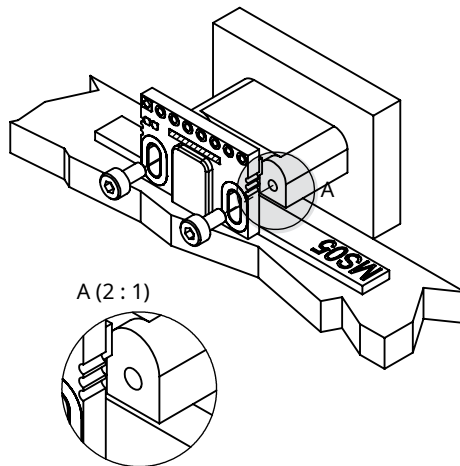
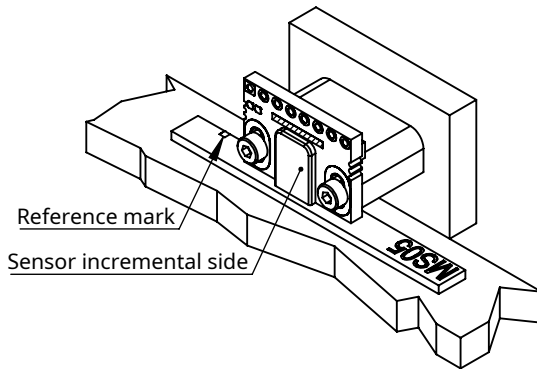

Images are for illustration purpose only. Valid for all versions.

### Position of installation holes

Recommended use of stainless steel, DIN912. For more information see [Table of recommended fastener tightening torques](#) at [RLS Media center](#).

**To avoid mechanical damage to the PCB assembly, do not use countersunk fasteners.**

- It is important that the space between the readhead and the magnetic scale is maintained over the entire measuring range.
- The magnetic encoder system must be used in accordance with the specified degree of protection. The following factors must be taken into account: IP protection class, operating temperature, external magnetic field, humidity level, mechanical load and EMC compatibility.
- The magnetic encoder system is sensitive to the external magnetic fields. The magnitude of the influence on the magnetic encoder system depends on the magnitude and direction of the external magnetic field. In particular, the rapidly changing stray magnetic fields affect the system and can alter its function. Magnetic field strength within 1 mT reduces the accuracy of the system. Field strengths greater than 1 mT will cause the system to malfunction and as a result the readhead will report an incorrect position. Magnetic field strengths greater than 25 mT will cause irreversible damage to the magnetic scale or ring and will have to be replaced.

## Technical specifications

### System data

<b>Pole length</b>	2 mm	
<b>Maximum measuring length</b>	50 m	
<b>System accuracy</b>	Linear application	$\pm 10 \mu\text{m/m}$ / $\pm 20 \mu\text{m/m}$ / $\pm 40 \mu\text{m/m}$
	MS05 magnetic scale	Different accuracy grades of MS05 magnetic scale available. Refer to MSD01 available at <a href="#">RLS Media center</a> .
	Rotary application	<b>Axial:</b> Refer to MR01D01 available at <a href="#">RLS media center</a> . <b>Radial:</b> Refer to MR02D02 available at <a href="#">RLS media center</a> .
<b>Hysteresis</b>	< 3 $\mu\text{m}$ (at 0.3 mm ride height)	
<b>Repeatability (unidirectional)</b>	< 1 $\mu\text{m}$	
<b>Reference mark</b>	Unique / Periodic	
<b>Set-up time</b>	< 10 ms (after power supply voltage is set in operating range)	
<b>Resolution</b>	Max. 13 bit ( $\sim 0.244 \mu\text{m}$ ) For details refer to the <a href="#">Table of available resolutions</a> .	
<b>Maximum speed</b>	Linear application	Refer to MSD01 available at <a href="#">RLS media center</a> .
	Rotary application	<b>Axial:</b> Refer to MR01D04 available at <a href="#">RLS media center</a> . <b>Radial:</b> Refer to speed calculator available at <a href="#">RLS website</a> .

### Electrical data

<b>Power supply</b>	5 V $\pm 0.25$ V – voltage on readhead
<b>Current consumption</b>	< 30 mA without 120 $\Omega$ termination < 130 mA with 120 $\Omega$ termination
<b>Reverse polarity protection</b>	Without reverse polarity protection.
<b>Maximum cable length</b>	10 m (Flex cable: 0.5 m ( $R \leq 0.75 \Omega/\text{m}$ ))
<b>Recommended wire gauge</b>	Through-hole: 21 AWG to 30 AWG

### Mechanical data

<b>Mass</b>	Through-hole	1.35 g
	With connector	$\sim 1.85$ g
<b>Connection types</b>	Molex 527451197, AMPHENOL 10114828-11108LF, Molex 5015681107, Through-hole	

### Environmental data

<b>Operating and storage temperature</b>	With Molex 527451197	-40 °C to +85 °C
	With Molex 5015681107 or AMPHENOL 10114828-11108LF	-40 °C to +105 °C
	Through-hole design	-40 °C to +125 °C
<b>Vibrations (55 Hz to 2000 Hz)</b>	300 m/s <sup>2</sup> (IEC 60068-2-6)	
<b>Shocks (6 ms)</b>	300 m/s <sup>2</sup> (IEC 60068-2-27)	
<b>Humidity</b>	70 % non condensing	
<b>External magnetic field during operation</b>	< 1 mT	
<b>ESD immunity</b>	HBM, Class 2 $\pm 2$ kV	

# Electrical connections



Function	Signal	Molex 527451197	Molex 501568-1107	AMPHENOL 10114828-11108LF	Through-hole
Power	Vdd	1	1, 2	1	1
	GND	2, 10	3, 4	2	8
Incremental signals	A+	6	5	4	6
	A-	7	6	3	7
	B+	8	7	5	4
	B-	9	8	6	5
Reference signals	Z+	3	10	8	2
	Z-	4	11	7	3
Cable shield	-	-	9	-	-
N.C.	-	5, 11	-	-	-

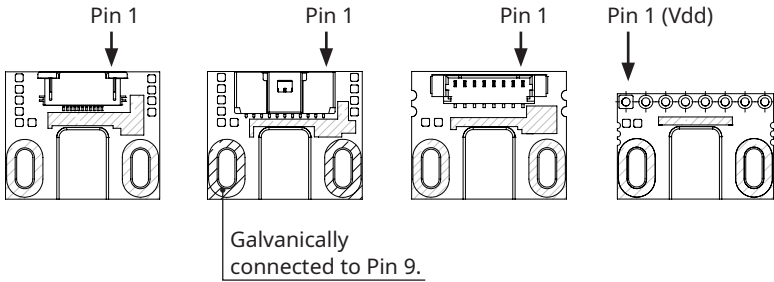

In configurations without reference mark the Z+ and Z- outputs maintain constant voltage potential levels of RS422 interface.



## Output type

### Incremental, RS422

RLC2IC

#### Specifications

<b>Output signals</b>	3 square-wave signals A, B, Z and their inverted signals A-, B-, Z-
<b>Reference signal</b>	1 or more square-wave pulse Z and its complementary pulse Z-
<b>Signal level</b>	Differential line driver according to EIA standard RS422
<b>Permissible load</b>	$Z_0 \geq 120 \Omega$ between associated outputs

#### Timing diagram

Complementary signals not shown

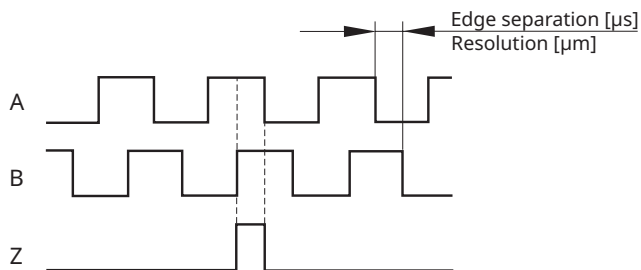

#### Recommended signal termination

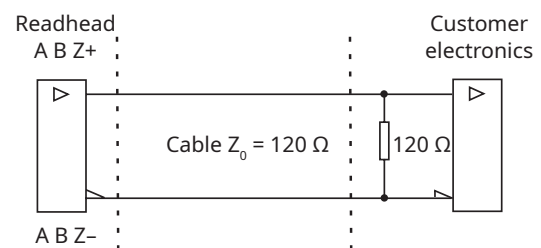

### Positive direction

Digital output signals – A leads B

For more information see the MSD01, MR02D02 or MR01D01 data sheets at [RLS Media center](#).

## Part numbering

	RLC	2	IC	A	13B	A	00	C	18
<b>Pole length</b> 2 - 2 mm									
<b>Output type</b> IC - Incremental, RS422; 5 V									
<b>Option</b> A - Standard									
<b>Interpolation factor (Resolutions)*</b>									
13B - 8192 (~0.244 µm)									
12B - 4096 (~0.488 µm)									
11B - 2048 (~0.976 µm)									
2D0 - 2000 (~1 µm)									
1D6 - 1600 (~1.25 µm)									
10B - 1024 (~1.953 µm)									
1D0 - 1000 (~2 µm)									
D80 - 800 (~2.5 µm)									
09B - 512 (~3.906 µm)									
D50 - 500 (~4 µm)									
D40 - 400 (~5 µm)									
D32 - 320 (~6.25 µm)									
08B - 256 (~7.812 µm)									
D20 - 200 (~10 µm)									
D16 - 160 (~12.5 µm)									
07B - 128 (~15.625 µm)									
D10 - 100 (~20 µm)									
D08 - 80 (~25 µm)									
06B - 64 (~31.25 µm)									
D04 - 40 (~50 µm)									
05B - 32 (~62.5 µm)									
04B - 16 (~125 µm)									
03B - 8 (~250 µm)									
* For exact values see <b>Table of available resolutions</b> on the following page.									
<b>Minimum edge separation</b>									
K - 0.07 µs (15 MHz)									
A - 0.12 µs (8 MHz)									
B - 0.5 µs (2 MHz)									
C - 1 µs (1 MHz)									
D - 2 µs (0.5 MHz)									
E - 4 µs (0.25 MHz)									
F - 5 µs (0.2 MHz)									
G - 10 µs (0.1 MHz)									
H - 20 µs (0.05 MHz)									
The customer's controller must support the selected edge separation time even if the encoder is used below the maximum speed.									
<b>Connector</b>									
00 - No connector, through-hole									
12 - Connector Molex 5015681107									
13 - Connector Molex 527451197									
20 - Connector AMPHENOL 10114828-11108LF									
<b>Reference mark</b>									
A - With unique reference mark Magnetic scale or ring must be ordered with reference mark.									
B - No reference mark									
C - Periodic reference mark as per scale pitch (every 2 mm) Reference periods correspond to pole length of magnetisation. Magnetic scale or ring must be ordered with <b>no</b> reference mark.									
<b>Special requirements</b>									
00/18 - No special requirements (standard)									

Encoder part numbers 00 or 18 are selected at the time of production based on material availability.  
This does not affect the fit/form/function of the encoder. Please contact [sales@rls.si](mailto:sales@rls.si) at the time of order.

Not all part number combinations are valid. Please refer to the table of available combinations on the next page for available options.

## Table of available combinations

Series	Pole length	Output type	Option	Interpolation factor	Minimum edge separation	Connector	Reference mark	Special requirements
RLC	2	IC	A	xxx*	K / A / B / C / D / E / F / G / H	00 / 12 / 13 / 20	A / B / C	00 / 18
				04B	A / B / C / D / E / F / G / H		B / C	
				03B	B / C / D / E / F / G / H			

\* Please check the table below for available interpolation factors.

For the part numbering of the MS incremental magnetic scale or the MR radial and axial incremental magnetic ring, refer to data sheets MSD01, MR02D02 and MR01D01 at [RLS Media Center](#).

## Available resolutions

Table of available resolutions

Part number	Pole length [mm]	Interpolation factor	Resolution [μm]
13B	2	2 <sup>13</sup>	0.244140625
12B		2 <sup>12</sup>	0.48828125
11B		2 <sup>11</sup>	0.9765625
2D0		2000	1
1D6		1600	1.25
10B		2 <sup>10</sup>	1.953125
1D0		1000	2
D80		800	2.5
09B		2 <sup>9</sup>	3.90625
D50		500	4
D40		400	5
D32		320	6.25
08B		2 <sup>8</sup>	7.8125
D20		200	10
D16		160	12.5
07B		2 <sup>7</sup>	15.625
D10		100	20
D08		80	25
06B		2 <sup>6</sup>	31.25
D04		40	50
05B		2 <sup>5</sup>	62.5
04B		2 <sup>4</sup>	125
03B		2 <sup>3</sup>	250

Resolutions calculation

$$\text{Resolution } [\mu\text{m}] = \frac{\text{Pole length } [\mu\text{m}]}{\text{Interpolation factor}} = \frac{2000}{\text{Interpolation factor}}$$

$$\text{Resolution [ppr]} = \frac{\text{Resolution [cpr]}}{4} = \frac{\text{Pole number}^* \times \text{Interpolation factor}}{4}$$

\*See pole numbers in the MR01D01 or MR02D02 data sheet at [RLS Media center](#).

# Accessories



Cable assembly  
**ACC054**



Cable assembly  
**ACC055**



Cable assembly  
**ACC056**



Cable assembly  
**ACC057**



USB encoder interface  
**E201-9Q**



Cable assembly  
**ACC058**

## ACC054

Part number	Length	Cable connector	RLC2IC connector	Termination
ACC054	1 m	Molex 501330-1100	Molex 501568-1107	Flying leads

Dimensions in mm.

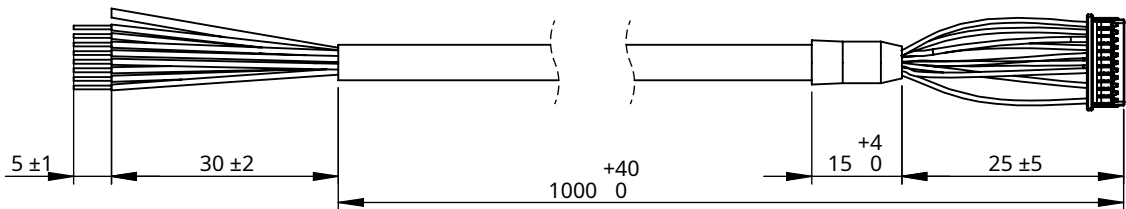

Flying leads	
Wire number	Wire color
1	Brown
2	White
3	Green
4	Yellow
5	Blue
6	Red
7	Shield
8	Pink
9	Grey

Molex 501330-1100		
Pin number	Signal	Color
1	V <sub>IN</sub> +5 V	Brown
2	V <sub>IN</sub> +5 V	NC
3	GND	White
4	GND	NC
5	A+	Green
6	A-	Yellow
7	B+	Blue
8	B-	Red
9	Shield	Black
10	Z+	Pink
11	Z-	Grey

## ACC055

Part number	Length	Cable connector	RLC2IC connector	Termination
ACC055	1 m	Molex 501330-1100	Molex 501568-1107	DB-9 connector

Dimensions in mm.

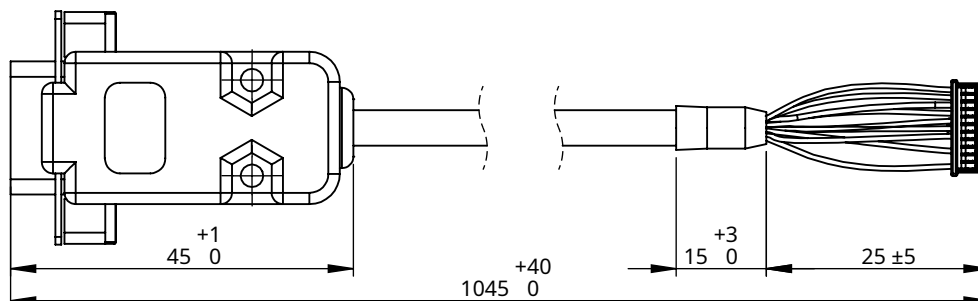

**DB-9 male connector  
(plastic housing)**

Pin number	Wire color
1	Shield
2	Pink
3	Blue
4	Green
5	Brown
6	Grey
7	Red
8	Yellow
9	White

**Molex 501330-1100**

Pin number	Signal	Wire color
1	V <sub>IN</sub> +5 V	Brown
2	V <sub>IN</sub> +5 V	NC
3	GND	White
4	GND	NC
5	A+	Green
6	A-	Yellow
7	B+	Blue
8	B-	Red
9	Shield	Black
10	Z+	Pink
11	Z-	Grey

ACC056

Part number	Length	Cable connector	RLC2IC connector	Termination
ACC056	1 m	Amphenol 10114826-00008LF	Amphenol 10114828-11108LF	Flying leads

Dimensions in mm.

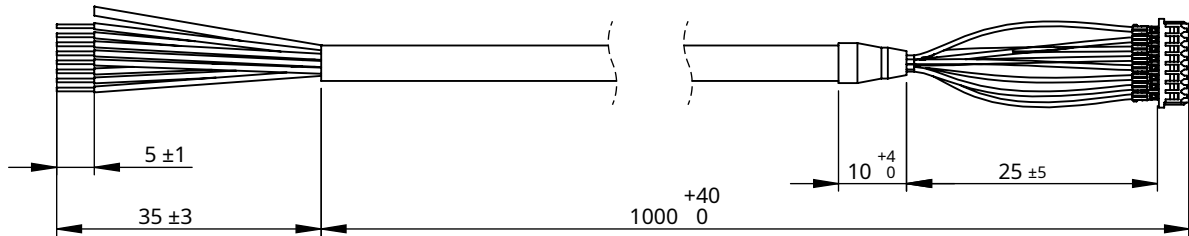

Flying leads	
Wire number	Wire color
1	Brown
2	White
3	Yellow
4	Green
5	Blue
6	Red
7	Grey
8	Pink
9	Shield

Amphenol 10114826-00008LF		
Pin number	Signal	Wire color
1	V <sub>dd</sub> (5 V)	Brown
2	GND	White
3	A-	Yellow
4	A+	Green
5	B+	Blue
6	B-	Red
7	Z-	Grey
8	Z+	Pink

## ACC057

Part number	Length	Cable connector	RLC2IC connector	Termination
ACC057	1 m	Amphenol 10114826-00008LF	Amphenol 10114828-11108LF	DB-9 connector

Dimensions in mm.

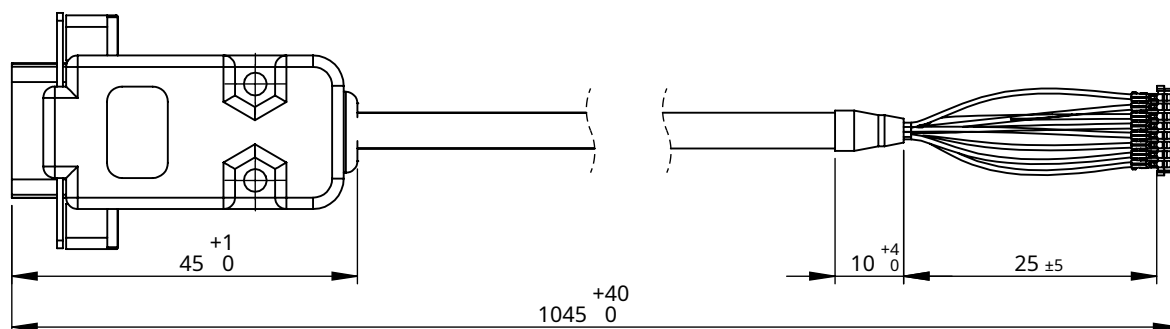

**DB-9 male connector  
(plastic housing)**

Pin number	Wire color
1	Shield
2	Pink
3	Blue
4	Green
5	Brown
6	Grey
7	Red
8	Yellow
9	White

**Amphenol 10114826-00008LF**

Pin number	Signal	Wire color
1	V <sub>dd</sub> (5 V)	Brown
2	GND	White
3	A-	Yellow
4	A+	Green
5	B+	Blue
6	B-	Red
7	Z-	Grey
8	Z+	Pink

## Cable assemblies

Part number	Length	Cable connector	RLC2IC connector	Termination
ACC058*	152 mm	–	RLC2IC - Molex 527451197	FFC connector

\* 20 cycles at 4 mm bending radius.

## Head office

---

### RLS Merilna tehnika d. o. o.

Poslovna cona Žeje pri Komendi  
Pod vrbami 2  
SI-1218 Komenda  
Slovenia

**T** +386 1 5272100  
**E** [mail@rls.si](mailto:mail@rls.si)  
[www.rls.si](http://www.rls.si)

## Global support

---

Visit our [website](#) to contact your nearest sales representative.

## Document issues

---

Date	Issue	Page	Description
29. 7. 2022	7	General	Dimension drawings amended, accessories added
4. 10. 2022	8	10 12, 15	Added Special requirement 00 in Part numbering Removed ACC059
7. 4. 2023	9	6 8	Installation instructions data added Electrical connections data amended

This product is not designed or intended for use outside the environmental limitations and operating parameters expressly stated on the product's datasheet. Products are not designed or intended for use in medical, military, aerospace, automotive or oil & gas applications or any safety-critical applications where a failure of the product could cause severe environmental or property damage, personal injury or death. Any use in such applications must be specifically agreed to by seller in writing, and is subject to such additional terms as the seller may impose in its sole discretion. Use of products in such applications is at buyer's own risk, and buyer will indemnify and hold harmless seller and its affiliates against any liability, loss, damage or expense arising from such use. Information contained in this datasheet was derived from product testing under controlled laboratory conditions and data reported thereon is subject to the stated tolerances and variations, or if none are stated, then to tolerances and variations consistent with usual trade practices and testing methods. The product's performance outside of laboratory conditions, including when one or more operating parameters is at its maximum range, may not conform to the product's datasheet. Further, information in the product's datasheet does not reflect the performance of the product in any application, end-use or operating environment buyer or its customer may put the product to. Seller and its affiliates make no recommendation, warranty or representation as to the suitability of the product for buyer's application, use, end-product, process or combination with any other product or as to any results buyer or its customer might obtain in their use of the product. Buyer should use its own knowledge, judgment, expertise and testing in selecting the product for buyer's application, end-use and/or operating environment, and should not rely on any oral or written statement, representation, or samples made by seller or its affiliates for any purpose. EXCEPT FOR THE WARRANTIES EXPRESSLY SET FORTH IN THE SELLER'S TERMS AND CONDITIONS OF SALE, SELLER MAKES NO WARRANTY EXPRESS OR IMPLIED WITH RESPECT TO THE PRODUCT, INCLUDING ANY WARRANTY OF MERCHANTABILITY OR FITNESS FOR ANY PARTICULAR PURPOSE, WHICH ARE DISCLAIMED AND EXCLUDED. All sales are subject to seller's exclusive terms and conditions of sale which, where the seller is (a) RLS Merilna tehnika d. o. o., are available at <https://www.rls.si/eng/salesterms>, (b) Renishaw, Inc., are available at <https://www.renishaw.com/legal/en/-/42186>, or (c) another person, are available on request, and in each case, are incorporated herein by reference, and are the exclusive terms of sale. No other terms and conditions apply. Buyer is not authorized to make any statements or representations that expand upon or extend the environmental limitations and operating parameters of the products, or which imply permitted usage outside of that expressly stated on the datasheet or agreed to in writing by seller.

RLS Merilna tehnika d. o. o. has made considerable effort to ensure the content of this document is correct at the date of publication but makes no warranties or representations regarding the content. RLS Merilna tehnika d. o. o. excludes liability, howsoever arising, for any inaccuracies in this document. © 2023 RLS d. o. o.